

POWER PAINTER CLEANUP MANUAL



CLEANUP

IMPORTANT!

The most important thing to know about your sprayer is proper cleanup and maintenance. Dried paints and stains act like glue and cause moving pieces to stick. Taking the time to properly clean and maintain your sprayer helps it last longer and work right every time.

IMPORTANT!

It is also very important to use the correct cleaning solutions when cleaning your sprayer.

- When using latex paints use lukewarm, soapy water or when cleaning your sprayer and components (DO NOT USE HOT WATER)
- When spraying with any material such as stains or oil based paints, use the type of solution recommended by the material's manufacturer or the original container.

WARNING

Never immerse electrical parts in water or any other liquid. Wipe the exterior of the sprayer with a damp cloth for cleaning. Always make sure the sprayer is unplugged before taking it apart for cleaning.

- 1** Unplug the sprayer. Pour the remaining material back into the original container.

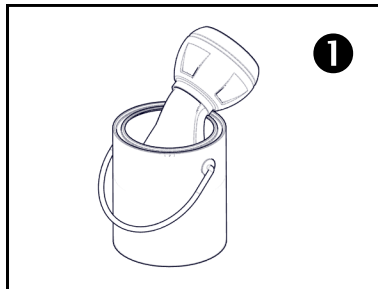

- 2** Fill the container half full of the cleaning solution appropriate to the type of material you sprayed. Plug in the sprayer.

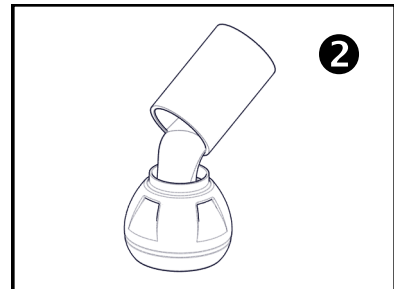

- 3** Squeeze the trigger until the solution comes through the sprayer for several seconds.

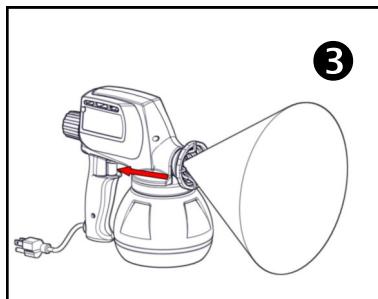

CAUTION

Be sure to spray the solution onto a scrap piece of wood or cardboard to prevent property damage.

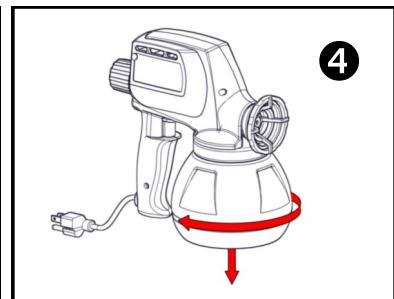

- 4** Unplug the sprayer. Remove the container and properly dispose of the remaining solution.

- 5** Make certain the sprayer is unplugged. Remove the suction set.

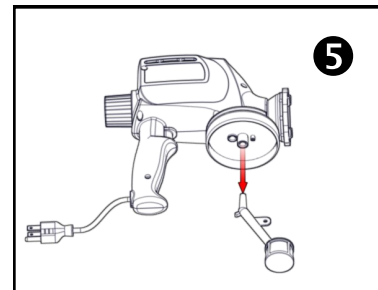

- 6** Turn the spray tip **counterclockwise** until it is removed. Pull out the Swirl Valve, being careful not to lose it.

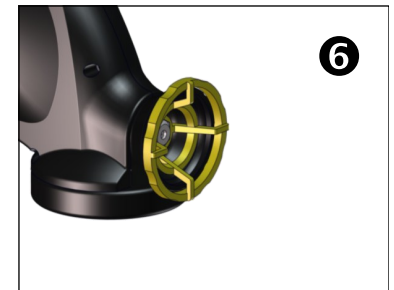

CLEANUP (CONTINUED)

- 7** Turn the locking nut **counterclockwise** until it is removed.

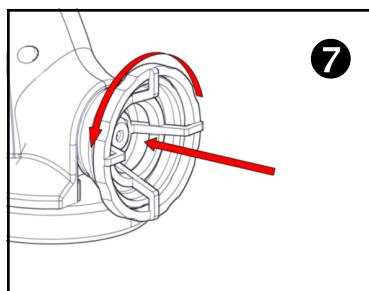

- 8** Slide the pump housing assembly off the sprayer.

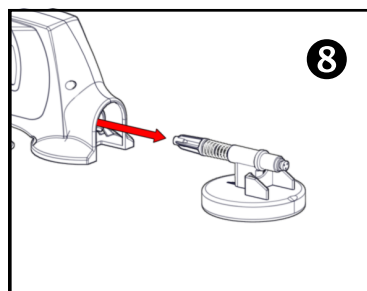

- 9** Pull the piston and spring off the pump housing.

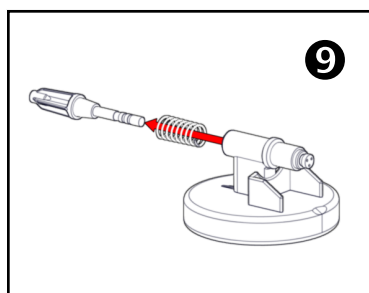

- 10** Clean all parts thoroughly with the brush provided using a solution appropriate to the type of material you sprayed.

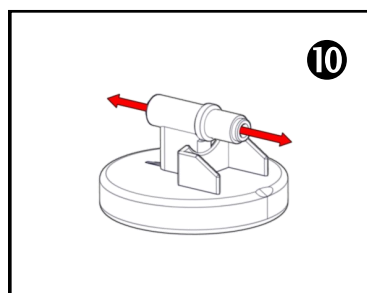

CAUTION

Make sure to completely remove all material from the inside of the piston chamber by scrubbing with the Brush. Even a small amount of material can dry like glue and keep the piston from moving, causing damage to the sprayer.

Make sure to keep the vent hole on the pump housing clean and unblocked or a vacuum can build up in the container and cause damage to the sprayer. A toothpick or straightened paper clip can be used to clean it.

CAUTION

To reassemble the paint sprayer, repeat the previous steps in reverse order.

Do not cross-thread the locking nut. Make certain it is threaded correctly before tightening. Make certain that the pump housing is pushed far enough onto the sprayer and the locking nut is screwed tightly.